



## ELECTRICAL SYSTEMS

### NDEC42 12/24 V

Part #	PARTS NAME NDE C42
<b>P035060</b>	<b>WRAPSTOP</b>
<b>P036033</b>	<b>UPPER STOP</b>
00057	Stop fixing screw
02103	Stop
02232	Upper bearing holder
01321	Plastic bearing 13mm (33/64") (two halves)
<b>E037020</b>	<b>COMPLETE STANDARD SWIVEL</b>
E037021	Standard swivel mechanism
01965	Standard swivel plate
P035013	Locked screw
P037029	Swivel bushing kit
00916	Shackle 8 mm
<b>E179020</b>	<b>COMPLETE "S" HALYARD SWIVEL</b>
E179021	"S" swivel mechanism
50384	"S" swivel mechanism
P035013	Locked screw
P037029	Swivel bushing kit
00196	Shackle 10 mm
<b>P037032</b>	<b>COMPLETE INTERMEDIATE EXTRUSION</b>
02234	Intermediate extrusion
<b>P036034</b>	<b>COMPLETE JOINING KIT</b>
02231	Joining torque link
01321	Plastic bearing 13mm (33/64") (two halves)
50567	Teat screw ST Hc M6 X 10
<b>P037031</b>	<b>COMPLETE LOWER EXTRUSION</b>
02233	Lower extrusion
02229	Lower bearing holder (two halves)
01321	Plastic bearing 13mm (33/64") (two halves)
50567	Teat screw ST Hc M6 X 10
05501	Teat screw ST Hc M6 X 8
50008	Feeder
<b>P190112</b>	<b>COMPLETE GEAR MOTOR 12 Volts (without fixing)</b>
<b>P190124</b>	<b>COMPLETE GEAR MOTOR 24 Volts (without fixing)</b>
02035	Double teat lower extrusion stop screw
P037014	Shape adapter
51076	Stuffing box
51069	Electric motor 12 Volts 700 W
51070	Electric motor 24 Volts 800 W
51071	O ring 45 X 1,5
51072	Screw CHc M5

P50718	Handle socket cap
P190043	Handle
51408	Square drive for drilling-machine
<b>P190111</b>	<b>FIXING</b>
50705	Screw for stainless stell tube
50828	Spacer
50716	Anti corrosion bushing
50715	Stainless steel ring
50714	Stainless steel tube
50717	Tube attachment pin
50753	Toggle
50911	Clevis pin $\phi$ 12
50912	Clevis pin $\phi$ 12,7 (1/2")
50913	Clevis pin $\phi$ 14 (9/16")
50914	Clevis pin $\phi$ 16 (5/8")
50915	Clevis pin $\phi$ 18
50916	Clevis pin $\phi$ 19 (3/4")
50917	Clevis pin $\phi$ 22 (7/8")
P190212	Chainplate threaded clevis pin $\phi$ 12 w. nuts and Nylon washers
P190222	Chainplate threaded clevis pin $\phi$ 12,7 (1/2") w. nuts and Nylon washers
P190232	Chainplate threaded clevis pin $\phi$ 14 (9/16") w. nuts and Nylon washers
P190242	Chainplate threaded clevis pin $\phi$ 16 (5/8") w. nuts and Nylon washers
P190252	Chainplate threaded clevis pin $\phi$ 18 w. nuts and Nylon washers
P190262	Chainplate threaded clevis pin $\phi$ 19 (3/4") w. nuts and Nylon washers
P190272	Chainplate threaded clevis pin $\phi$ 22 (7/8") w. nuts and Nylon washers
00094	Locknut M12
00095	Stainless washer $\phi$ 12mm
50011	Nylon washer $\phi$ 12mm
<b>P037070</b>	<b>Turnbuckle cylinder (OPTION "I")</b>
01436	Teat lower extrusion stop screw
04446	Relay box 12 V
04447	Relay box 24 V
50162	Magneto thermic circuit breaker 12 volt
51157	Magneto thermic circuit breaker 24 volt

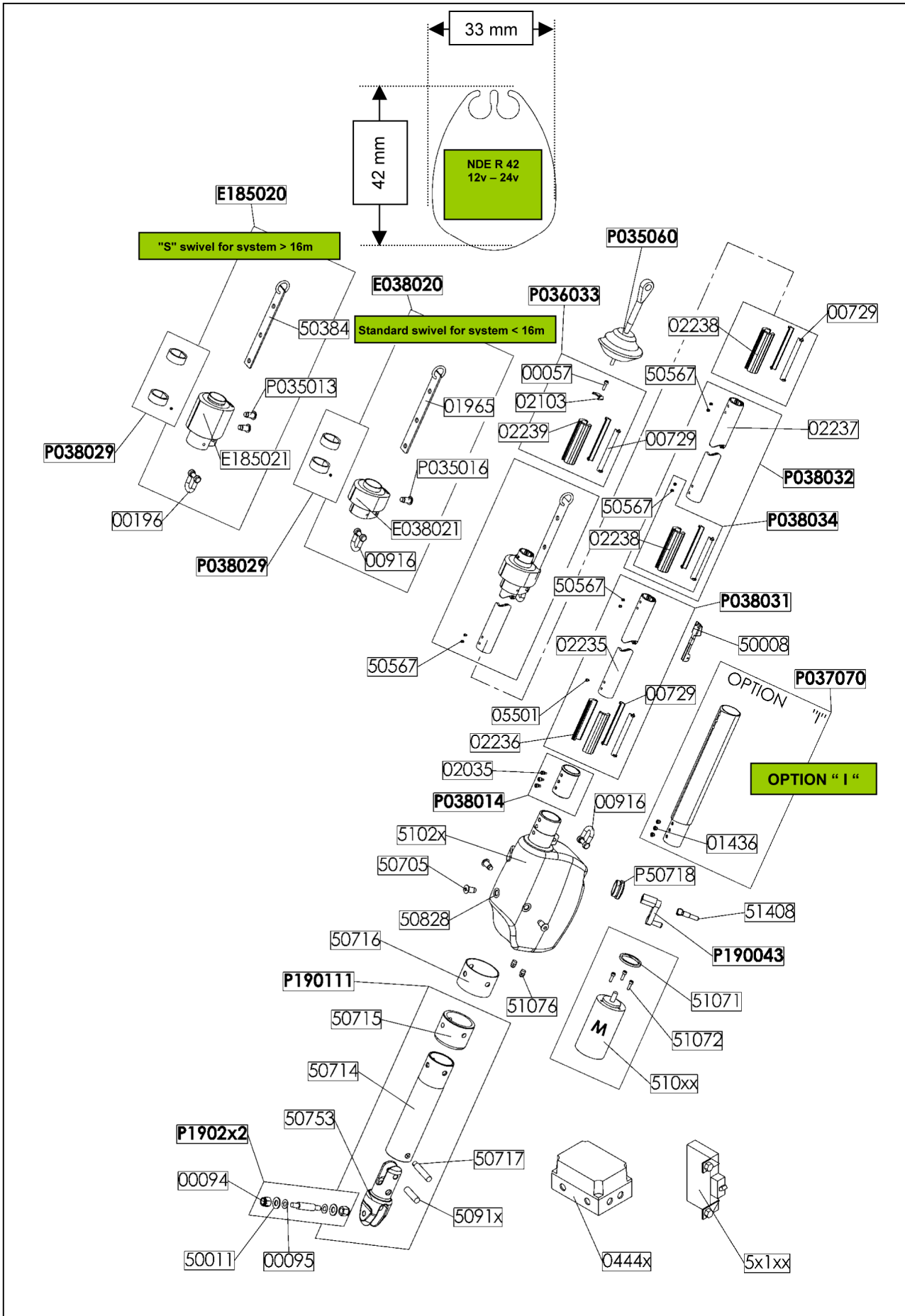



## NDER 42

## 12/24V

Part #	PARTS NAME NDE R42	P190111	FIXING
P035060	WRAPSTOP	50705	Screw for stainless stell tube
P036033	UPPER STOP	50828	Spacer
00057	Stop fixing screw	50716	Anti corrosion bushing
02103	Stop	50715	Stainless steel ring
02239	Upper bearing holder	50714	Stainless steel tube
00729	Plastic bearing 11mm (27/64") (two	50717	Tube attachment pin
E038020	COMPLETE STANDARD SWIVEL	50753	Toggle
E038021	Standard swivel mechanism	50911	Clevis pin $\phi$ 12
01965	Standard swivel plate	50912	Clevis pin $\phi$ 12,7 (1/2")
P035013	Locked screw	50913	Clevis pin $\phi$ 14 (9/16")
P038029	Swivel bushing kit	50914	Clevis pin $\phi$ 16 (5/8")
00916	Shackle 8 mm	50915	Clevis pin $\phi$ 18
E179020	COMPLETE "S" HALYARD SWIVEL	50916	Clevis pin $\phi$ 19 (3/4")
E179021	"S" swivel mechanism	50917	Clevis pin $\phi$ 22 (7/8")
50384	"S" swivel mechanism		Chainplate threaded clevis pin $\phi$ 12 w. nuts and
P035013	Locked screw	P190212	Nylon washers
P038029	Swivel bushing kit		Chainplate threaded clevis pin $\phi$ 12,7 (1/2") w.
00196	Shackle 10 mm	P190222	nuts and Nylon washers
P038032	COMPLETE INTERMEDIATE EXTR		Chainplate threaded clevis pin $\phi$ 14 (9/16") w.
02237	Intermediate extrusion	P190232	nuts and Nylon washers
P038034	COMPLETE JOINING KIT		Chainplate threaded clevis pin $\phi$ 16 (5/8") w.
02238	Joining torque link	P190242	nuts and Nylon washers
00729	Plastic bearing 11mm (27/64") (two		Chainplate threaded clevis pin $\phi$ 18 w. nuts and
50567	Teat screw ST Hc M6 X 10	P190252	Nylon washers
P038031	COMPLETE LOWER EXTRUSION		Chainplate threaded clevis pin $\phi$ 19 (3/4") w.
02235	Lower extrusion	P190262	nuts and Nylon washers
02236	Lower bearing holder (two halves)		Chainplate threaded clevis pin $\phi$ 22 (7/8") w.
00729	Plastic bearing 11mm (27/64") (two	P190272	nuts and Nylon washers
50567	Teat screw ST Hc M6 X 10	00094	Locknut M12
05501	Teat screw ST Hc M6 X 8	00095	Stainless washer $\phi$ 12mm
50008	Feeder	50011	Nylon washer $\phi$ 12mm
	COMPLETE GEAR MOTOR 12 Volt	P037070	Turnbuckle cylinder (OPTION "I")
P195112	fixing)	01436	Teat lower extrusion stop screw
	COMPLETE GEAR MOTOR 24 Volt	04446	Relay box 12 V
P195124	fixing)	04447	Relay box 24 V
02035	Double teat lower extrusion stop scre	50162	Magneto thermic circuit breaker 12 volt
P038014	Shape adapter	51157	Magneto thermic circuit breaker 24 volt
51076	Stuffing box		
51069	Electric motor 12 Volts 700 W		
51070	Electric motor 24 Volts 800 W		
51071	O ring 45 X 1,5		
51072	Screw CHc M5		
P50718	Handle socket cap		
P190043	Handle		
51408	Square drive for drilling-machine		

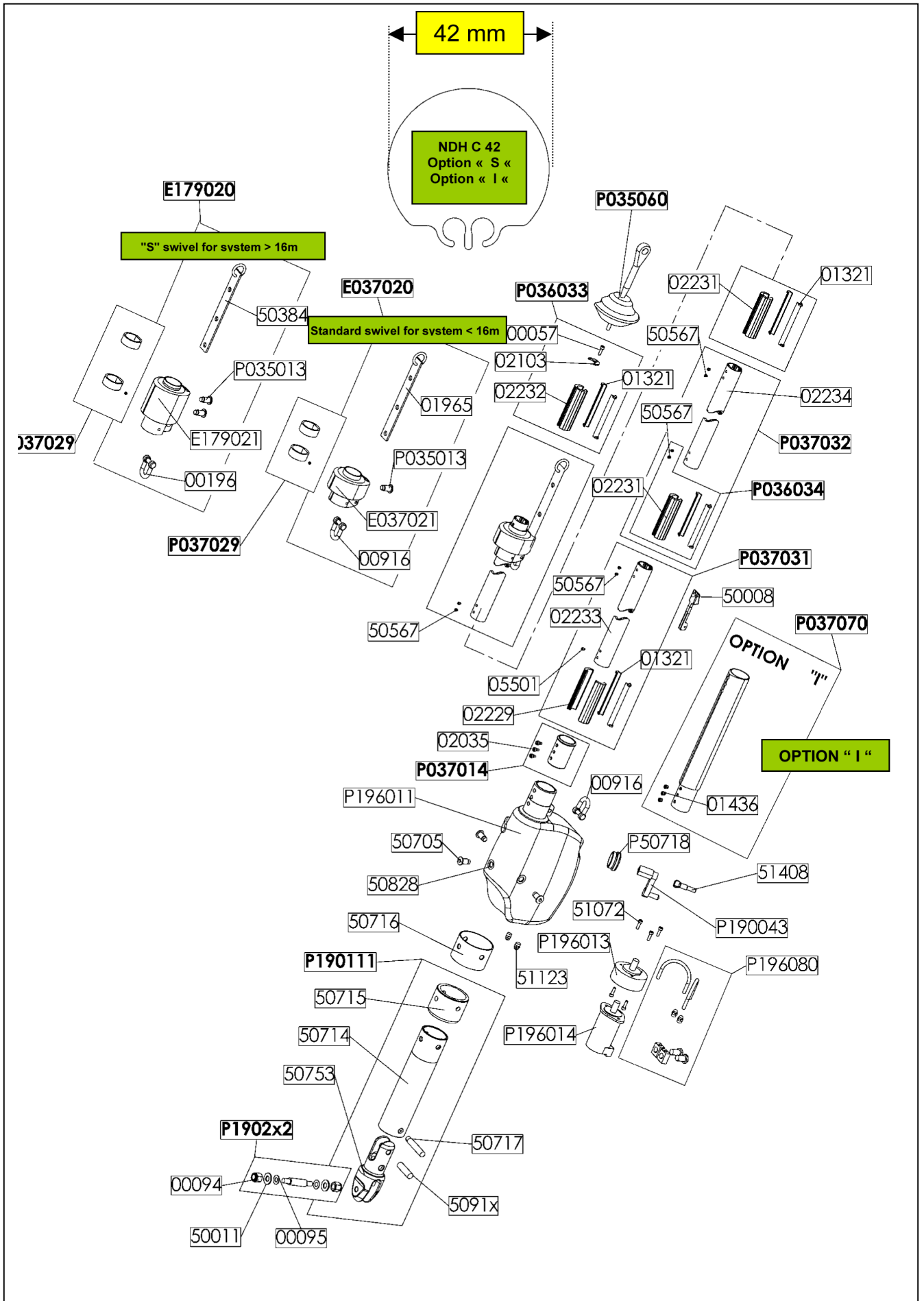



## NDH C 42 12/24V

Part #	PARTS NAME NDH C42
<b>P035060</b>	<b>WRAPSTOP</b>
<b>P036033</b>	<b>UPPER STOP</b>
00057	Stop fixing screw
02103	Stop
02232	Upper bearing holder
01321	Plastic bearing 13mm (33/64") (two halves)
<b>E037020</b>	<b>COMPLETE STANDARD SWIVEL</b>
E037021	Standard swivel mechanism
01965	Standard swivel plate
P035013	Locked screw
P037029	Swivel bushing kit
00916	Shackle 8 mm
<b>E179020</b>	<b>COMPLETE "S" HALYARD SWIVEL</b>
E179021	"S" swivel mechanism
50384	"S" swivel mechanism
P035013	Locked screw
P037029	Swivel bushing kit
00196	Shackle 10 mm
<b>P037032</b>	<b>COMPLETE INTERMEDIATE EXTRUSION</b>
02234	Intermediate extrusion
<b>P036034</b>	<b>COMPLETE JOINING KIT</b>
02231	Joining torque link
01321	Plastic bearing 13mm (33/64") (two halves)
50567	Teat screw ST Hc M6 X 10
<b>P037031</b>	<b>COMPLETE LOWER EXTRUSION</b>
02233	Lower extrusion
02229	Lower bearing holder (two halves)
01321	Plastic bearing 13mm (33/64") (two halves)
50567	Teat screw ST Hc M6 X 10
05501	Teat screw ST Hc M6 X 8
50008	Feeder
<b>P196112</b>	<b>COMPLETE GEAR MOTOR (without fixing)</b>
P196011	Gear motor only ( no lower fittings )
02035	Double teat lower extrusion stop screw
P037014	Shape adapter
51123	Outlet connector 7/16" JIC
P196014	Hydraulic motor only
P196013	Hydraulic motor adapter
P196080	Tube fittings and connector
51072	Screw CHc M5
P50718	Handle socket cap
P190043	Handle
51408	Square drive for drilling-machine
<b>P190111</b>	<b>FIXING</b>
50705	Screw for stainless stell tube
50828	Spacer

50716	Anti corrosion bushing
0715	Stainless steel ring
50714	Stainless steel tube
50717	Tube attachment pin
50753	Toggle
50911	Clevis pin $\phi$ 12
50912	Clevis pin $\phi$ 12,7 (1/2")
50913	Clevis pin $\phi$ 14 (9/16")
50914	Clevis pin $\phi$ 16 (5/8")
50915	Clevis pin $\phi$ 18
50916	Clevis pin $\phi$ 19 (3/4")
50917	Clevis pin $\phi$ 22 (7/8")
P190212	Chainplate threaded clevis pin $\phi$ 12 w. nuts and Nylon washers
P190222	Chainplate threaded clevis pin $\phi$ 12,7 (1/2") w. nuts and Nylon washers
P190232	Chainplate threaded clevis pin $\phi$ 14 (9/16") w. nuts and Nylon washers
P190242	Chainplate threaded clevis pin $\phi$ 16 (5/8") w. nuts and Nylon washers
P190252	Chainplate threaded clevis pin $\phi$ 18 w. nuts and Nylon washers
P190262	Chainplate threaded clevis pin $\phi$ 19 (3/4") w. nuts and Nylon washers
P190272	Chainplate threaded clevis pin $\phi$ 22 (7/8") w. nuts and Nylon washers
00094	Locknut M12
00095	Stainless washer $\phi$ 12mm
50011	Nylon washer $\phi$ 12mm
<b>P037070</b>	<b>Turnbuckle cylinder (OPTION "I")</b>
01436	Teat lower extrusion stop screw

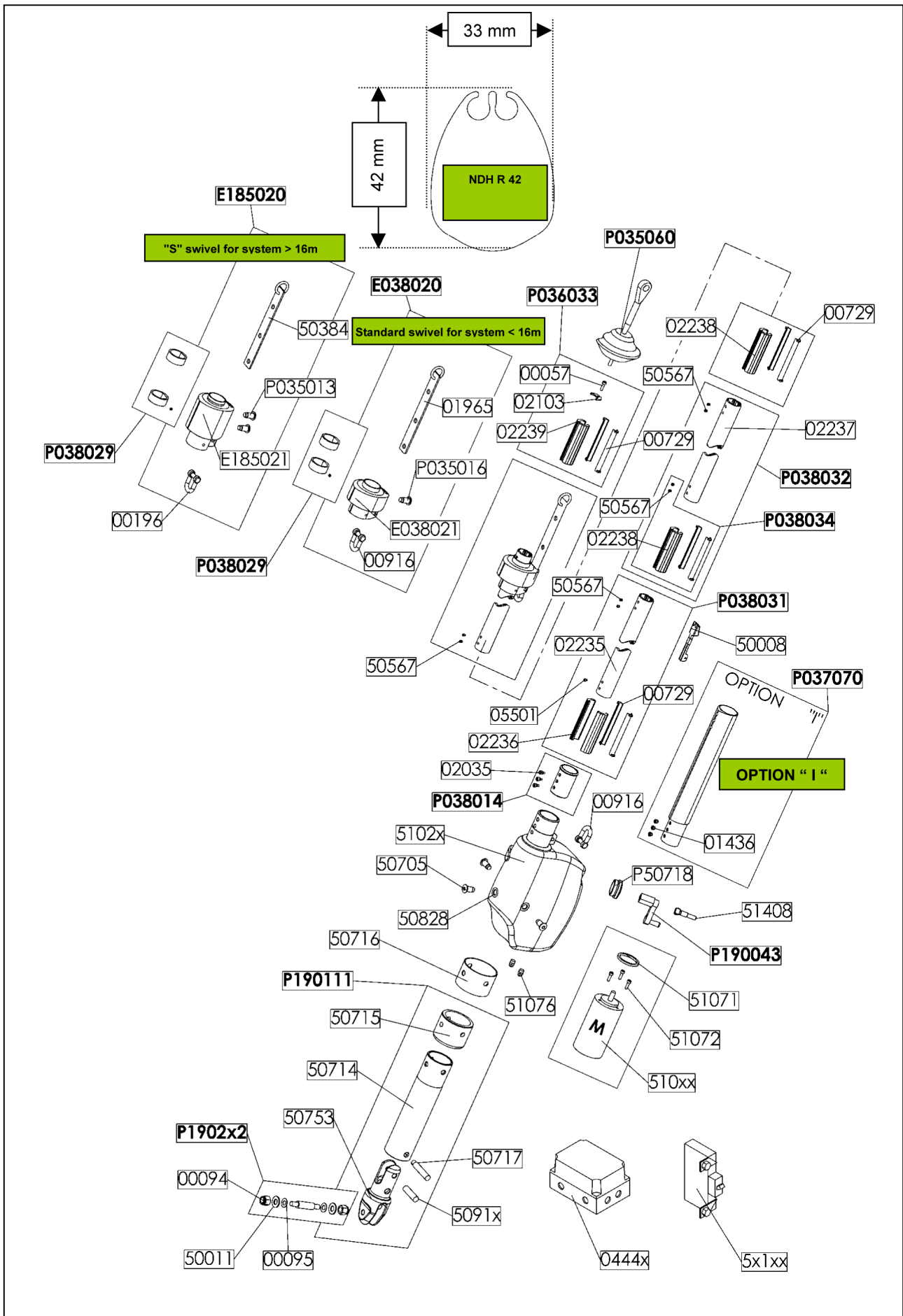



**NDH R 42**

**12/24V**

Part #	PARTS NAME NDH R42
<b>P035060</b>	<b>WRAPSTOP</b>
<b>P036033</b>	<b>UPPER STOP</b>
00057	Stop fixing screw
02103	Stop
02239	Upper bearing holder
00729	Plastic bearing 11mm (27/64") (two halves)
<b>E038020</b>	<b>COMPLETE STANDARD SWIVEL</b>
E038021	Standard swivel mechanism
01965	Standard swivel plate
P035013	Locked screw
P038029	Swivel bushing kit
00916	Shackle 8 mm
<b>E179020</b>	<b>COMPLETE "S" HALYARD SWIVEL</b>
E179021	"S" swivel mechanism
50384	"S" swivel mechanism
P035013	Locked screw
P038029	Swivel bushing kit
00196	Shackle 10 mm
<b>P038032</b>	<b>COMPLETE INTERMEDIATE EXTRUSION</b>
02237	Intermediate extrusion
<b>P038034</b>	<b>COMPLETE JOINING KIT</b>
02238	Joining torque link
00729	Plastic bearing 11mm (27/64") (two halves)
50567	Teat screw ST Hc M6 X 10
<b>P038031</b>	<b>COMPLETE LOWER EXTRUSION</b>
02235	Lower extrusion
02236	Lower bearing holder (two halves)
00729	Plastic bearing 11mm (27/64") (two halves)
50567	Teat screw ST Hc M6 X 10
05501	Teat screw ST Hc M6 X8
50008	Feeder
<b>P197112</b>	<b>COMPLETE GEAR MOTOR (without fixing)</b>
P196011	Gear motor only ( no lower fittings )
02035	Double teat lower extrusion stop screw
P038014	Shape adapter
51123	Outlet connector 7/16" JIC
P196014	Hydraulic motor only
P196013	Hydraulic motor adapter
P196080	Tube fittings and connector
51072	Screw CHc M5
P50718	Handle socket cap
P190043	Handle

51408	Square drive for drilling-machine
<b>P190111</b>	<b>FIXING</b>
50705	Screw for stainless stell tube
50828	Spacer
50716	Anti corrosion bushing
50715	Stainless steel ring
50714	Stainless steel tube
50717	Tube attachment pin
50753	Toggle
50911	Clevis pin $\phi$ 12
50912	Clevis pin $\phi$ 12,7 (1/2")
50913	Clevis pin $\phi$ 14 (9/16")
50914	Clevis pin $\phi$ 16 (5/8")
50915	Clevis pin $\phi$ 18
50916	Clevis pin $\phi$ 19 (3/4")
50917	Clevis pin $\phi$ 22 (7/8")
P190212	Chainplate threaded clevis pin $\phi$ 12 w. nuts and Nylon washers
P190222	Chainplate threaded clevis pin $\phi$ 12,7 (1/2") w. nuts and Nylon washers
P190232	Chainplate threaded clevis pin $\phi$ 14 (9/16") w. nuts and Nylon washers
P190242	Chainplate threaded clevis pin $\phi$ 16 (5/8") w. nuts and Nylon washers
P190252	Chainplate threaded clevis pin $\phi$ 18 w. nuts and Nylon washers
P190262	Chainplate threaded clevis pin $\phi$ 19 (3/4") w. nuts and Nylon washers
P190272	Chainplate threaded clevis pin $\phi$ 22 (7/8") w. nuts and Nylon washers
00094	Locknut M12
00095	Stainless washer $\phi$ 12mm
50011	Nylon washer $\phi$ 12mm
<b>P037070</b>	<b>Turnbuckle cylinder (OPTION "I")</b>
01436	Teat lower extrusion stop screw



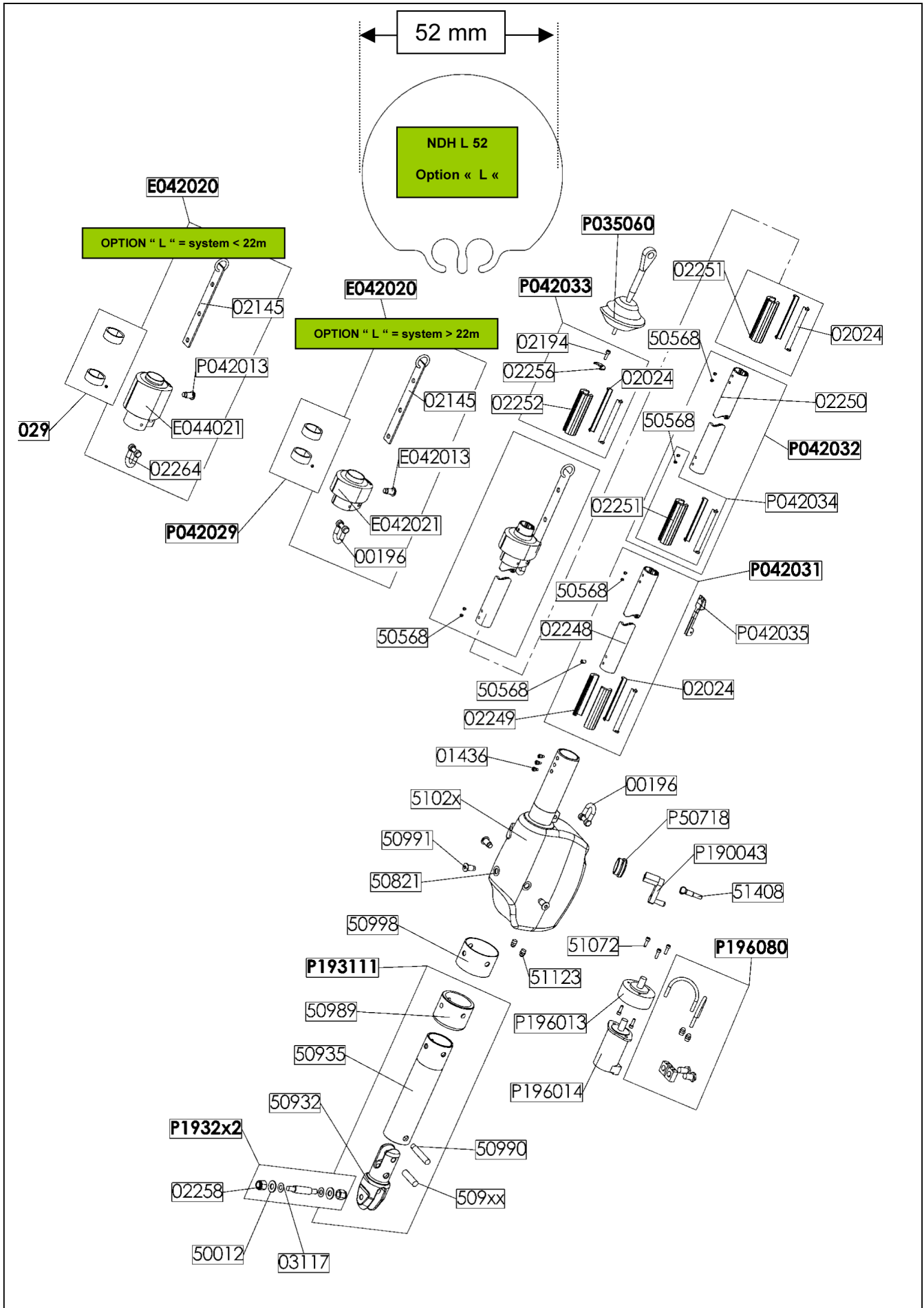



## NDH L 52

## 12/24V

Part #	PARTS NAME NDH I		
<b>P035060</b>	<b>WRAPSTOP</b>	51408	Square drive for drilling-machine
<b>P042033</b>	<b>UPPER STOP</b>	<b>P193111</b>	<b>FIXING</b>
02194	Stop fixing screw	50991	Screw for stainless stell tube
02256	Stop	50821	Spacer
02252	Upper bearing holder	50988	Anti corrosion bushing
02024	Plastic bearing 17mm (43/64 halves)	50989	Stainless steel ring
<b>E042020</b>	<b>COMPLETE STANDARD SWIVEL MECHANISM</b>	50935	Stainless steel tube
E042021	Standard swivel mechanism	50990	Tube attachment pin
02145	Standard swivel plate	50932	Toggle
P042013	Locked screw	50918	Clevis pin $\phi$ 16mm (5/8")
P042029	Swivel bushing kit	50919	Clevis pin $\phi$ 18mm
00196	Shackle 8 mm	50920	Clevis pin $\phi$ 19mm (3/4")
<b>E044020</b>	<b>COMPLETE "S" HALYARD SWIVEL MECHANISM</b>	50921	Clevis pin $\phi$ 22mm (7/8")
E044021	"S" swivel mechanism	50922	Clevis pin $\phi$ 25mm (1")
02145	"S" swivel mechanism	50923	Clevis pin $\phi$ 27mm (1 1/16")
P042013	Locked screw	50924	Clevis pin $\phi$ 29mm (1 9/64")
P042029	Swivel bushing kit	P193212	Chainplate threaded clevis pin $\phi$ 16mm (5/8") with nuts and washers
02264	Shackle 8 mm	P193222	Chainplate threaded clevis pin $\phi$ 18mm with nuts and washers
<b>P042032</b>	<b>COMPLETE INTERMEDIATE EXTRUSION</b>	P193232	Chainplate threaded clevis pin $\phi$ 19mm (3/4") with nuts and washers
02250	Intermediate extrusion	P193242	Chainplate threaded clevis pin $\phi$ 22mm (7/8") with nuts and washers
<b>P042034</b>	<b>COMPLETE JOINING KIT</b>	P193252	Chainplate threaded clevis pin $\phi$ 25mm (1") with nuts and washers
02251	Joining torque link	P193262	Chainplate threaded clevis pin $\phi$ 27mm (1 1/16") with nuts and washers
02024	Plastic bearing 17mm (43/64 halves)	P193272	Chainplate threaded clevis pin $\phi$ 29mm (1 9/64") with nuts and washers
50568	Teat screw ST Hc M6 X	02258	Locknut M14
<b>P042031</b>	<b>COMPLETE LOWER EXTRUSION</b>	03117	Stainless washer $\phi$ 14mm
02248	Lower extrusion	50012	Nylon washer $\phi$ 14mm
02249	Lower bearing holder (two halves)		
02024	Plastic bearing 17mm (43/64 halves)		
50568	Teat screw ST Hc M6 X		
P042035	Feeder		
<b>P198112</b>	<b>COMPLETE GEAR MOTOR (fixing)</b>		
P196011	Gear motor only ( no lower fittings )		
02035	Double teat lower extrusion stop screw		
51123	Outlet connector 7/16" JIC		
P196014	Hydraulic motor only		
P196013	Hydraulic motor adapter		
P198080	Tube fittings and connector		
51072	Screw CHc M5		
P50718	Handle socket cap		
P190043	Handle		

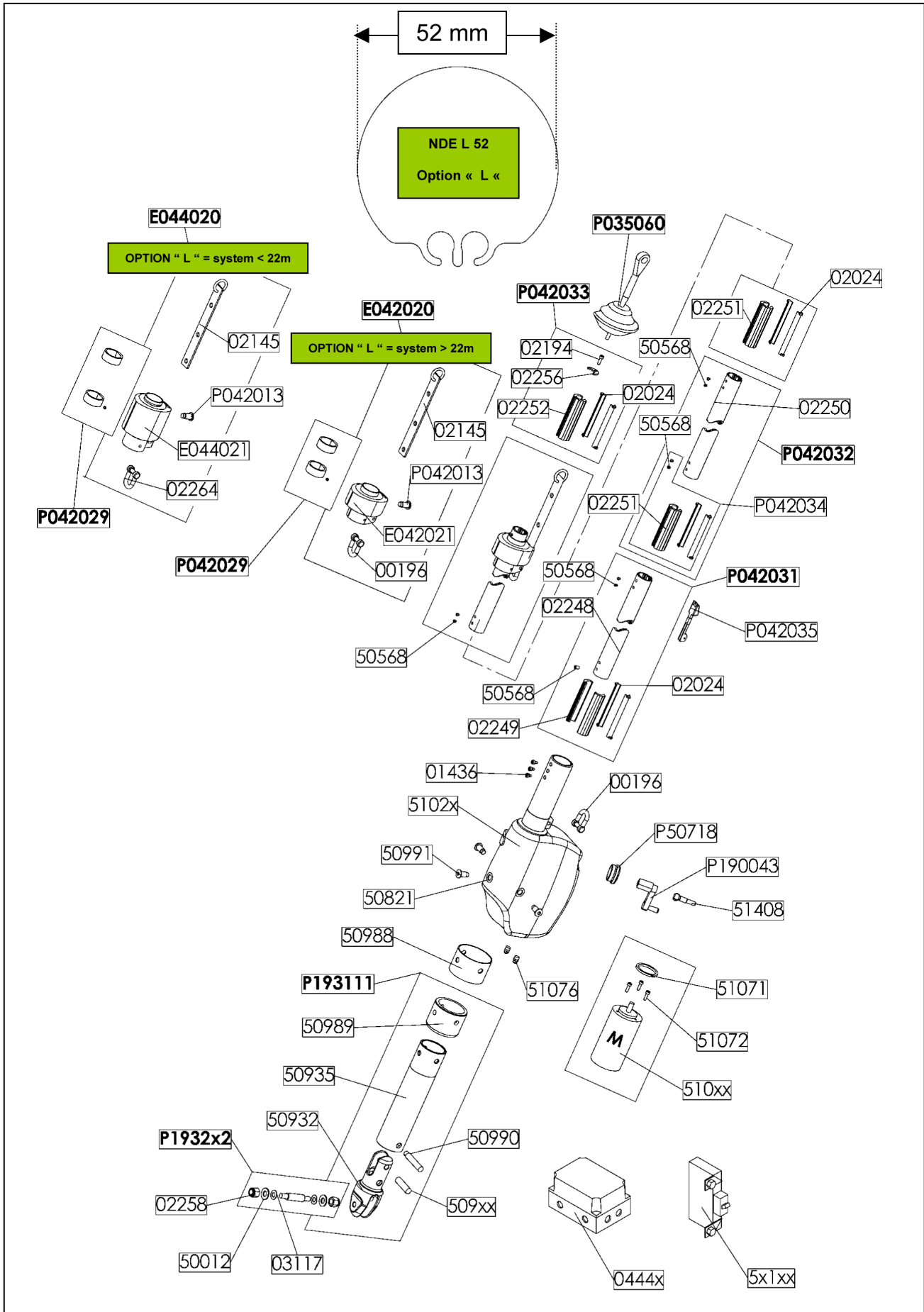

## NDE L52 12/24V

Part #	PARTS NAME NDE L52
<b>P035060</b>	<b>WRAPSTOP</b>
<b>P042033</b>	<b>UPPER STOP</b>
02194	Stop fixing screw
02256	Stop
02252	Upper bearing holder
02024	Plastic bearing 17mm (43/64") (two halves)
<b>E042020</b>	<b>COMPLETE STANDARD SWIVEL</b>
E042021	Standard swivel mechanism
02145	Standard swivel plate
P042013	Locked screw
P042029	Swivel bushing kit
00196	Shackle 8 mm
<b>E044020</b>	<b>COMPLETE "S" HALYARD SWIVEL</b>
E044021	"S" swivel mechanism
02145	"S" swivel mechanism
P042013	Locked screw
P042029	Swivel bushing kit
02264	Shackle 8 mm
<b>P042032</b>	<b>COMPLETE INTERMEDIATE EXTRUSION</b>
02250	Intermediate extrusion
<b>P042034</b>	<b>COMPLETE JOINING KIT</b>
02251	Joining torque link
02024	Plastic bearing 17mm (43/64") (two halves)
50568	Teat screw ST Hc M6 X 10
<b>P042031</b>	<b>COMPLETE LOWER EXTRUSION</b>
02248	Lower extrusion
02249	Lower bearing holder (two halves)
02024	Plastic bearing 17mm (43/64") (two halves)
50568	Teat screw ST Hc M6 X 10
P042035	Feeder
<b>P193112</b>	<b>COMPLETE GEAR MOTOR 12 Volts (without fixing)</b>
<b>P193124</b>	<b>COMPLETE GEAR MOTOR 24 Volts (without fixing)</b>
01436	Double teat lower extrusion stop screw
51076	Stuffing box
51069	Electric motor 12 Volts 700 W
51070	Electric motor 24 Volts 800 W
51071	O ring 45 X 1,5
51072	Screw CHc M5
P50718	Handle socket cap
P190043	Handle
51408	Square drive for drilling-machine

<b>P193111</b>	<b>FIXING</b>
50991	Screw for stainless stell tube
50821	Spacer
50988	Anti corrosion bushing
50989	Stainless steel ring
50935	Stainless steel tube
50990	Tube attachment pin
50932	Toggle
50918	Clevis pin $\phi$ 16mm (5/8")
50919	Clevis pin $\phi$ 18mm
50920	Clevis pin $\phi$ 19mm (3/4")
50921	Clevis pin $\phi$ 22mm (7/8")
50922	Clevis pin $\phi$ 25mm (1' )
50923	Clevis pin $\phi$ 27mm ( 1'1/16 )
50924	Clevis pin $\phi$ 29mm ( 1'9/64 )
P193212	Chainplate threaded clevis pin $\phi$ 16mm (5/8") with nuts and washers
P193222	Chainplate threaded clevis pin $\phi$ 18mm with nuts and washers
P193232	Chainplate threaded clevis pin $\phi$ 19mm (3/4") with nuts and washers
P193242	Chainplate threaded clevis pin $\phi$ 22mm (7/8") with nuts and washers
P193252	Chainplate threaded clevis pin $\phi$ 25mm ( 1' ) with nuts and washers
P193262	Chainplate threaded clevis pin $\phi$ 27mm ( 1'1/16 ) with nuts and washers
P193272	Chainplate threaded clevis pin $\phi$ 29mm ( 1'9/64 ) with nuts and washers
02258	Locknut M14
03117	Stainless washer $\phi$ 14mm
50012	Nylon washer $\phi$ 14mm
04446	Relay box 12 V
04447	Relay box 24 V
50162	Magneto thermic circuit breaker 12 volt
51157	Magneto thermic circuit breaker 24 volt