

## PROFURL EXPLODED OLD SYSTEMS DIAGRAMS AND PARTS LISTS

### L31

Part #	Parts name L31 & Li 31
P039060	<b>WRAPSTOP</b>
P039033	<b>UPPER STOP</b>
00057	Stop fixing screw
00056	Stop
02217	Top ending bearing holder
00051	Plastic sleeve (Ø 8,5 mm/11/32") two halves
P039020	<b>COMPLETE SWIVEL</b>
P039021	Swivel mechanism
00195	6 mm shackle
02019	Halyard swivel plate
P039013	Locked screw
P039029	Swivel bushing kit
P039032	<b>COMPLETE INTERMEDIATE LUFF EXTRUSION (2M, 6'6 23/32")</b>
02215	Intermediate luff extrusion
P039034	Complete joining kit
02216	Joining torque link
00051	Plastic sleeve (Ø 8,5 mm, 11/32") two halves
00052	Screw ST HC M6X6
P039031	<b>COMPLETE LOWER LUFF EXTRUSION</b>
02213	Lower luff extrusion
02214	Lower ending bearing holders (two halves)
00051	Plastic sleeve (Ø 8,5 mm, 11/32") two halves
00052	Screw ST HC M6X6
00053	Feeder stop screw
02168	<b>Feeder</b>
P040010	<b>COMPLETE STANDARD N 31 DRUM MECHANISM</b>
P039011	Standard drum mechanism
00195	6 mm shackle
P040012	N 31 drum
00065	Drum screw
05004	N 31 & Ni 31 drum cage arm
P039013	Drum cage fixing locked screw
02133	Link plate fixing screw
P039111	<b>SHORT LINK PLATES (without pin)</b>
02080	Smooth clevis pin Ø 8 mm (5/16")
02081	Smooth clevis pin Ø 10 mm (3/8")
02083	Smooth clevis pin Ø 11 mm (7/16")
02084	Smooth clevis pin Ø 12 mm
05508	Smooth clevis pin Ø 12,7 mm (1/2")
02086	Smooth clevis pin Ø 14 mm (9/16")
02860	Smooth clevis pin Ø 16 mm (5/8")
P039160	Set of metric smooth clevis pins (Ø 8-10-12-14-16 mm)
P039170	Set of imperial smooth clevis pins (Ø 5/16"-3/8"-7/16"-1/2"-9/16"-5/8")
P039211	<b>LONG LINK PLATES (without pin)</b>
P039222	Threaded clevis pin with washer and locknut Ø 10 mm (3/8")
P039232	Threaded clevis pin with washer and locknut Ø 11 mm (7/16")
P039242	Threaded clevis pin with washer and locknut Ø 12 mm (1/2")
P039262	Threaded clevis pin with washer and locknut Ø 12,7 mm (1/2")
P039252	Threaded clevis pin with washer and locknut Ø 14 mm (9/16")
P039282	Threaded clevis pin with washer and locknut Ø 16 mm (5/8")
01224	Locknut M10
50110	Nylon washer
P039260	Set of metric threaded clevis pins (Ø 10-12-14-16 mm)
P039270	Set of imperial threaded clevis pins (Ø 3/8"-7/16"-1/2"-9/16"-5/8")
P124010	<b>COMPLETE Li 31 DRUM MECHANISM (includes turnbuckle cylinder)</b>
P121011	Li 31 drum mechanism (includes turnbuckle cylinder)
05144	Screw for "i" drum mechanism lower extrusion
P165012	"i" Drum
00917	Drum screw for "i" drum mechanism

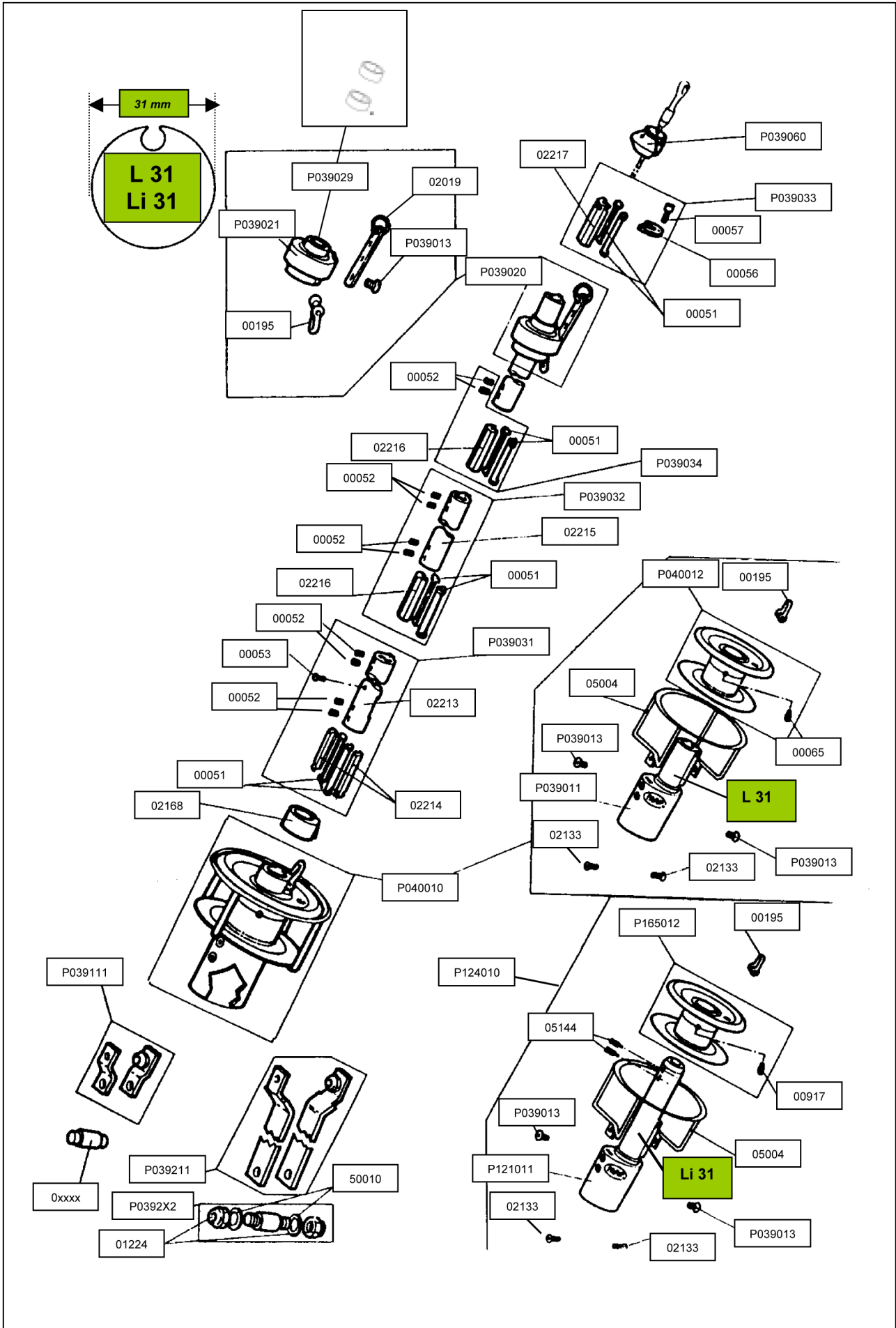

## N31

Part #	Parts name N 31 &		
P039060	<b>WRAPSTOP</b>		
P039033	<b>UPPER STOP</b>		
00057	Stop fixing screw		
00056	Stop		
02217	Top ending bearing hc		
00051	Plastic sleeve (Ø 8,5 mm/11/32		
P039020	<b>COMPLETE SWIVE</b>		
P039021	Swivel mechanism		
00195	6 mm shackle		
02019	Halyard swivel plat		
P039013	Locked screw		
P039029	Swivel bushing kit		
P039032	<b>COMPLETE INTERMEDIA EXTRUSION (2M, 6'6 2</b>		
02215	Intermediate luff extru		
P039034	Complete joining ki		
02216	Joining torque link		
00051	Plastic sleeve (Ø 8,5 mm, 11/32		
00052	Screw ST HC M6X		
P039031	<b>COMPLETE LOWER LUFF E</b>		
02213	Lower luff extrusior		
02214	Lower ending bearing holders		
00051	Plastic sleeve (Ø 8,5 mm, 11/32		
00052	Screw ST HC M6X		
00053	Feeder stop screw		
02168	<b>Feeder</b>		
P039010	<b>COMPLETE STANDARD N MECHANISM</b>		
P039011	Standard drum mecha		
00195	6 mm shackle		
P039012	N 31 drum		
00065	Drum screw		
05005	N 31 & Ni 31 drum cage		
P039013	Drum cage fixing locked		
02133	Link plate fixing scre		
P039111	<b>SHORT LINK PLATES (wit</b>		
02080	Smooth clevis pin Ø 8 mm (5/16")		
02081	Smooth clevis pin Ø 10 mm (3/8 ")		
02083	Smooth clevis pin Ø 11 mm (7/16")		
02084	Smooth clevis pin Ø 12 mm		
05508	Smooth clevis pin Ø 12,7 mm (1/2")		
02086	Smooth clevis pin Ø 14 mm (9/16")		
02860	Smooth clevis pin Ø 16 mm ( 5/8")		
P039160	Set of metric smooth clevis pins (Ø 8-10-12-14-16 mm)		
P039170	Set of imperial smooth clevis pins (Ø 5/16"-3/8"-7/16"-1/2"-9/16"-5/8")		
P039211	<b>LONG LINK PLATES (without pin)</b>		
P039222	Threaded clevis pin with washer and locknut Ø 10 mm (3/8")		
P039232	Threaded clevis pin with washer and locknut Ø 11 mm (7/16")		
P039242	Threaded clevis pin with washer and locknut Ø 12 mm		
P039262	Threaded clevis pin with washer and locknut Ø 12,7 mm (1/2")		
P039252	Threaded clevis pin with washer and locknut Ø 14 mm (9/16")		
P039282	Threaded clevis pin with washer and locknut Ø 16 mm (5/8")		
01224	Locknut M10		
50010	Nylon washer		
P039260	Set of metric threaded clevis pins (Ø 10-12-14-16 mm)		
P039270	Set of imperial threaded clevis pins (Ø 3/8"-7/16"-1/2"-9/16"-5/8")		
P121010	<b>COMPLETE Li 31 DRUM MECHANISM (includes turnbuckle cylinder)</b>		
P121011	Li 31 drum mechanism (includes turnbuckle cylinder)		
05144	Screw for "i" drum mechanism lower extrusion		
P150012	"i" Drum		
00917	Drum screw for "i" drum mechanism		

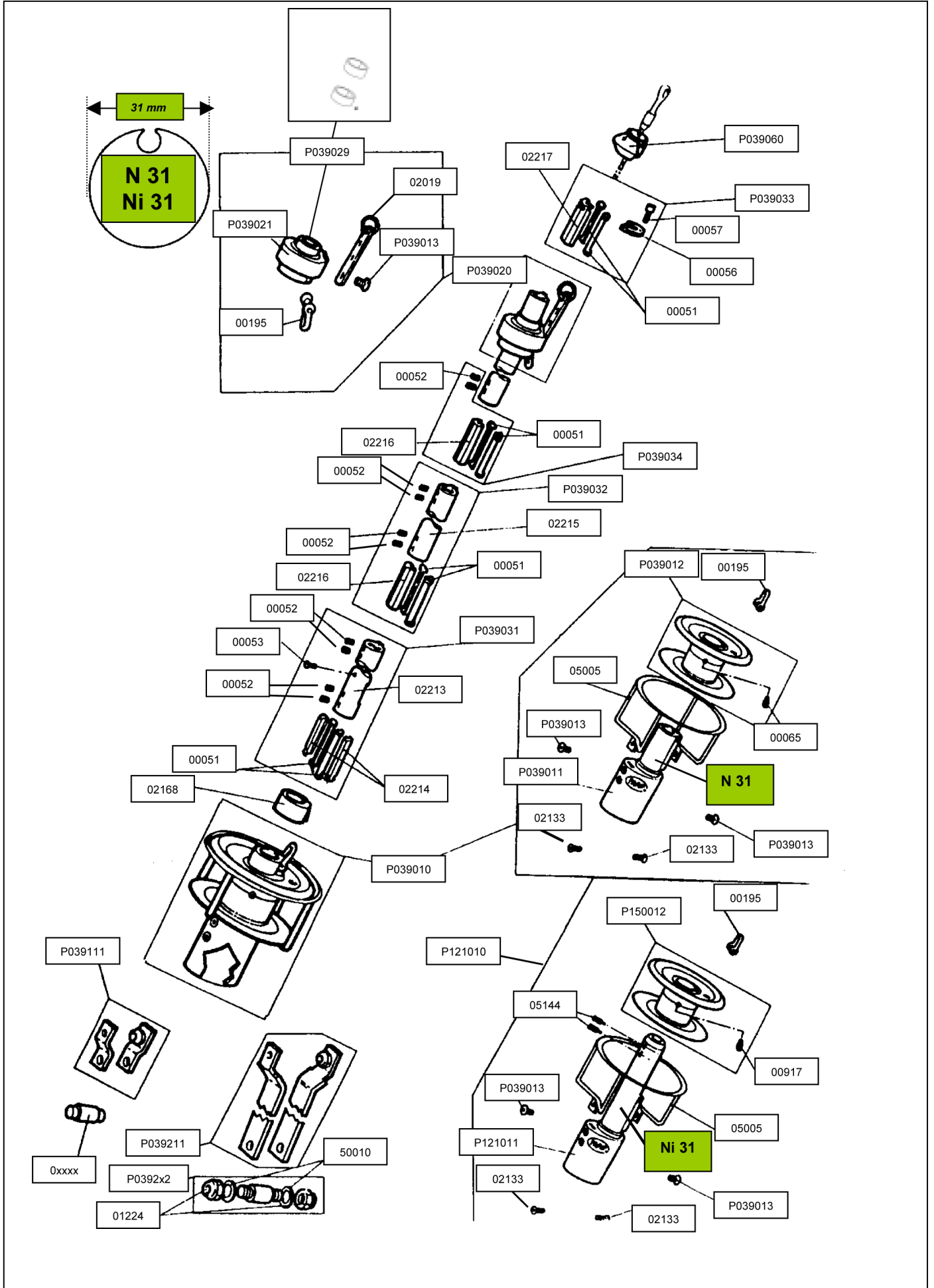

## L42

Part #	Parts name L 42 & Li 42
<b>P035060</b>	<b>WRAPSTOP</b>
<b>P036033</b>	<b>UPPER STOP</b>
00057	Stop fixing screw
02103	Stop
02232	Top ending bearing holder
01321	Plastic sleeve (13 mm / 33/64") two halves
<b>P035020</b>	<b>COMPLETE SWIVEL</b>
P035021	Swivel mechanism
00916	8 mm shackle
01965	Halyard swivel plate
P035013	Locked screw
P035029	Swivel bushing kit
<b>P036032</b>	<b>COMPLETE INTERMEDIATE LUFF EXTRUSION (2M, 6'6 23/32")</b>
02230	Intermediate luff extrusion
P036034	Complete joining kit
02231	Joining torque link
01321	Plastic sleeve (13 mm / 33/64") two halves
00052	Screw ST HC M6X6
<b>P036031</b>	<b>COMPLETE LOWER LUFF EXTRUSION</b>
02228	Lower luff extrusion
02229	Lower ending bearing holders (two halves)
01321	Plastic sleeve (13 mm / 33/64") two halves
00052	Screw ST HC M6X6
00053	Feeder stop screw
02169	<b>Feeder</b>
<b>P036010</b>	<b>COMPLETE STANDARD L 42 DRUM MECHANISM</b>
P036011	Standard drum mechanism
00916	8 mm shackle
P036012	L 42 drum
00116	Drum screw
05002	L 42 & Li 42 drum cage arm
P035013	Drum cage fixing locked screw
02131	Link plate fixing screw
<b>P035111</b>	<b>SHORT LINK PLATES (without pin)</b>
02073	Smooth clevis pin Ø 12 mm
05510	Smooth clevis pin Ø 12,7 mm (1/2")
02039	Smooth clevis pin Ø 14 mm (9/16")
02040	Smooth clevis pin Ø 16 mm (5/8")
02041	Smooth clevis pin Ø 18 mm
02042	Smooth clevis pin Ø 19 mm (3/4")
03217	Smooth clevis pin Ø 22 mm (7/8")

P035160	Set of metric smooth clevis pins (Ø 12-14-16-18 mm)
P035170	Set of imperial smooth clevis pins (Ø 1/2"-9/16"-5/8"-3/4")
<b>P035211</b>	<b>LONG LINK PLATES (without pin)</b>
P035212	Threaded clevis pin with washer and locknut Ø 12 mm
P035262	Threaded clevis pin with washer and locknut Ø 12,7 mm (1/2")
P035222	Threaded clevis pin with washer and locknut Ø 14 mm (9/16")
P035232	Threaded clevis pin with washer and locknut Ø 16 mm (5/8")
P035242	Threaded clevis pin with washer and locknut Ø 18 mm
P035252	Threaded clevis pin with washer and locknut Ø 19 mm (3/4")
P035282	Threaded clevis pin with washer and locknut Ø 22 mm (7/8")
00094	Locknut M12
50011	Nylon washer
P035260	Set of metric threaded clevis pins (Ø 10-12-14-16 mm)
P035270	Set of imperial threaded clevis pins (Ø 1/2"-9/16"-5/8"-3/4")
<b>P120010</b>	<b>COMPLETE Li 42 DRUM MECHANISM (includes turnbuckle cylinder)</b>
P125011	Li 42 drum mechanism (includes turnbuckle cylinder)
01436	Screw for "i" drum mechanism lower extrusion
P120012	"i" drum mechanism
00918	Drum screw for "i" drum mechanism

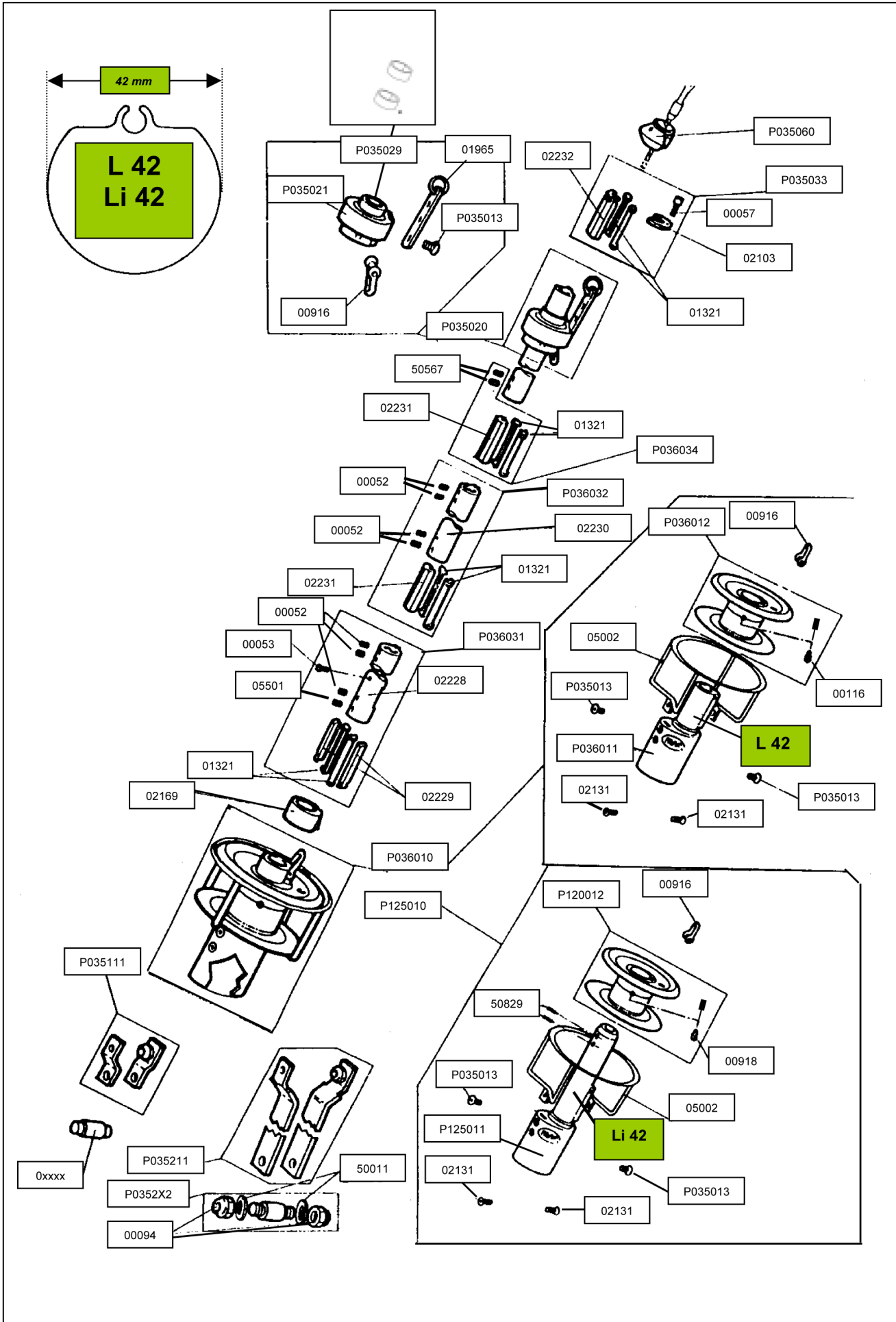





## N42

Part #	Parts name N 42 & Ni 42
<b>P035060</b>	<b>WRAPSTOP</b>
<b>P035033</b>	<b>UPPER STOP</b>
00057	Stop fixing screw
02103	Stop
02232	Top ending bearing holder
01320	Plastic sleeve Ø 11.5 mm / 29/64" ( two halves)
<b>P035020</b>	<b>COMPLETE SWIVEL</b>
P035021	Swivel mechanism
00916	8 mm shackle
01965	Halyard swivel plate
P035013	Locked screw
P035029	Swivel bushing kit
<b>P035032</b>	<b>COMPLETE INTERMEDIATE LUFF EXTRUSION (2M, 6'6 23/32")</b>
02230	Intermediate luff extrusion
P035034	Complete joining kit
02231	Joining torque link
01320	Plastic sleeve Ø 11.5 mm / 29/64" ( two halves)
50567	Screw ST HC M6X6
<b>P035031</b>	<b>COMPLETE LOWER LUFF EXTRUSION</b>
02228	Lower luff extrusion
02229	Lower ending bearing holders (two halves)
01320	Plastic sleeve Ø 11.5 mm / 29/64" ( two halves)
00052	Screw ST HC M6X6
00053	Feeder stop screw
02169	<b>Feeder</b>
<b>P035010</b>	<b>COMPLETE STANDARD N 42 DRUM MECHANISM</b>
P035011	Standard drum mechanism
00916	8 mm shackle
P035012	N 42 drum
00116	Drum screw
05003	N 42 & Ni 42 drum cage arm
P035013	Drum cage fixing locked screw
02131	Link plate fixing screw
05144	Screw for standard drum mechanism lower extrusion
<b>P035111</b>	<b>SHORT LINK PLATES (without pin)</b>
02073	Smooth clevis pin Ø 12 mm
05510	Smooth clevis pin Ø 12,7 mm (1/2")
02039	Smooth clevis pin Ø 14 mm (9/16")
02040	Smooth clevis pin Ø 16 mm ( 5/8")
02041	Smooth clevis pin Ø 18 mm
02042	Smooth clevis pin Ø 19 mm ( 3/4")

03217	Smooth clevis pin Ø 22 mm ( 7/8")
P035160	Set of metric smooth clevis pins (Ø 12-14-16-18 mm)
P035170	Set of imperial smooth clevis pins (Ø 1/2"-9/16"-5/8"-3/4")
<b>P035211</b>	<b>LONG LINK PLATES (without pin)</b>
P035212	Threaded clevis pin with washer and locknut Ø 12 mm
P035262	Threaded clevis pin with washer and locknut Ø 12,7 mm (1/2")
P035222	Threaded clevis pin with washer and locknut Ø 14 mm (9/16")
P035232	Threaded clevis pin with washer and locknut Ø 16 mm (5/8")
P035242	Threaded clevis pin with washer and locknut Ø 18 mm
P035252	Threaded clevis pin with washer and locknut Ø 19 mm (3/4")
P035262	Threaded clevis pin with washer and locknut Ø 22 mm (7/8")
00094	Locknut M12
50011	Nylon washer
P035260	Set of metric threaded clevis pins (Ø 10-12-14-16 mm)
P035270	Set of imperial threaded clevis pins (Ø 1/2"-9/16"-5/8"-3/4")
<b>P125010</b>	<b>COMPLETE Li 31 DRUM MECHANISM (includes turnbuckle cylinder)</b>
P125011	Li 31 drum mechanism (includes turnbuckle cylinder)
01436	Screw for "i" drum mechanism lower extrusion
P125012	"i" drum mechanism
00918	Drum screw for "i" drum mechanism

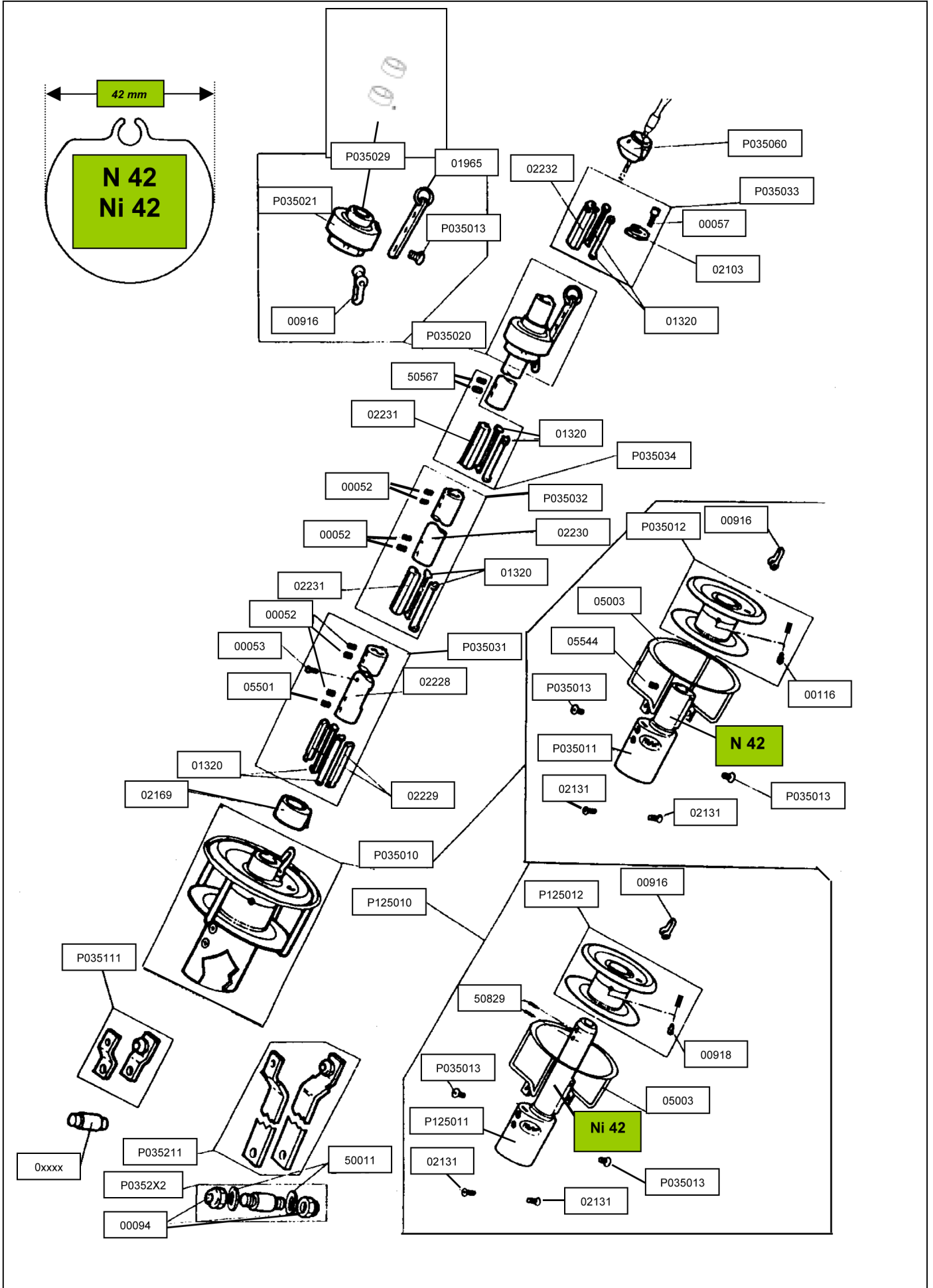





## LC42 R

Part #	Parts name LC42 R & LCi 42 R
<b>P035060</b>	<b>WRAPSTOP</b>
<b>P122033</b>	<b>UPPER STOP</b>
00057	Stop fixing screw
02103	Stop
50276	Top ending bearing holder (600 mm long)
50277	Plastic sleeve (13 mm / 33/64") two halves
<b>P129020</b>	<b>COMPLETE SWIVEL LC 42R &amp; LCi 42R</b>
P129021	Swivel mechanism LC 42R & LCi 42R
50314	HR shackle Ø 12 mm
P035029	Swivel bushing kit
<b>P122032</b>	<b>COMPLETE INTERMEDIATE LUFF EXTRUSION (2 m, 6'6 23/32")</b>
50279	Intermediate luff extrusion
P122034	<b>COMPLETE JOINING KIT</b>
50275	Joining torque link
50277	Plastic sleeve (13 mm / 33/64") two halves
50380	Screw ST HC M6X6
<b>P122031</b>	<b>COMPLETE LOWER LUFF EXTRUSION</b>
50278	Lower luff extrusion
02229	Lower ending bearing holders (two halves)
01321	Plastic sleeve (13 mm / 33/64") two halves
50380	Screw ST HC M6X6
50380	Screw ST HC M6X8 for lower bearing holder
<b>P133035</b>	<b>Feeder</b>
05363	Feeder set screw
<b>P122010</b>	<b>COMPLETE LC 42R STANDARD DRUM MECHANISM</b>
P122011	Standard drum mechanism
02264	HR shackle Ø 10 mm
P122012	Drum
00918	Drum screw for standard drum mechanism
50323	Drum cage arm
P035013	Drum cage fixing locked screw
02144	SS inserts fixing screw
<b>50687</b>	<b>SS inserts</b>
02073	Smooth clevis pin Ø 12 mm (1/2")
02039	Smooth clevis pin Ø 14 mm (9/16 ")
02040	Smooth clevis pin Ø 16 mm (5/8")
02041	Smooth clevis pin Ø 18 mm
02042	Smooth clevis pin Ø 19 mm (3/4")
03217	Smooth clevis pin Ø 22 mm ( 7/8")
P035160	Set of metric smooth clevis pins ( Ø 12-14-16-18-19-22 mm)
P035170	Set of imperial smooth clevis pins ( Ø 1/2"-9/16"-5/8"-3/4")
<b>P129010</b>	<b>COMPLETE LCi 42R DRUM MECHANISM (includes turnbuckle cylinder)</b>
P129011	LCi 42 drum mechanism (includes turnbuckle cylinder)
50324	Screw for "i" drum mechanism lower extrusion
00918	Drum screw for LCi 42R drum mechanism
05002	Drum cage arm "i"

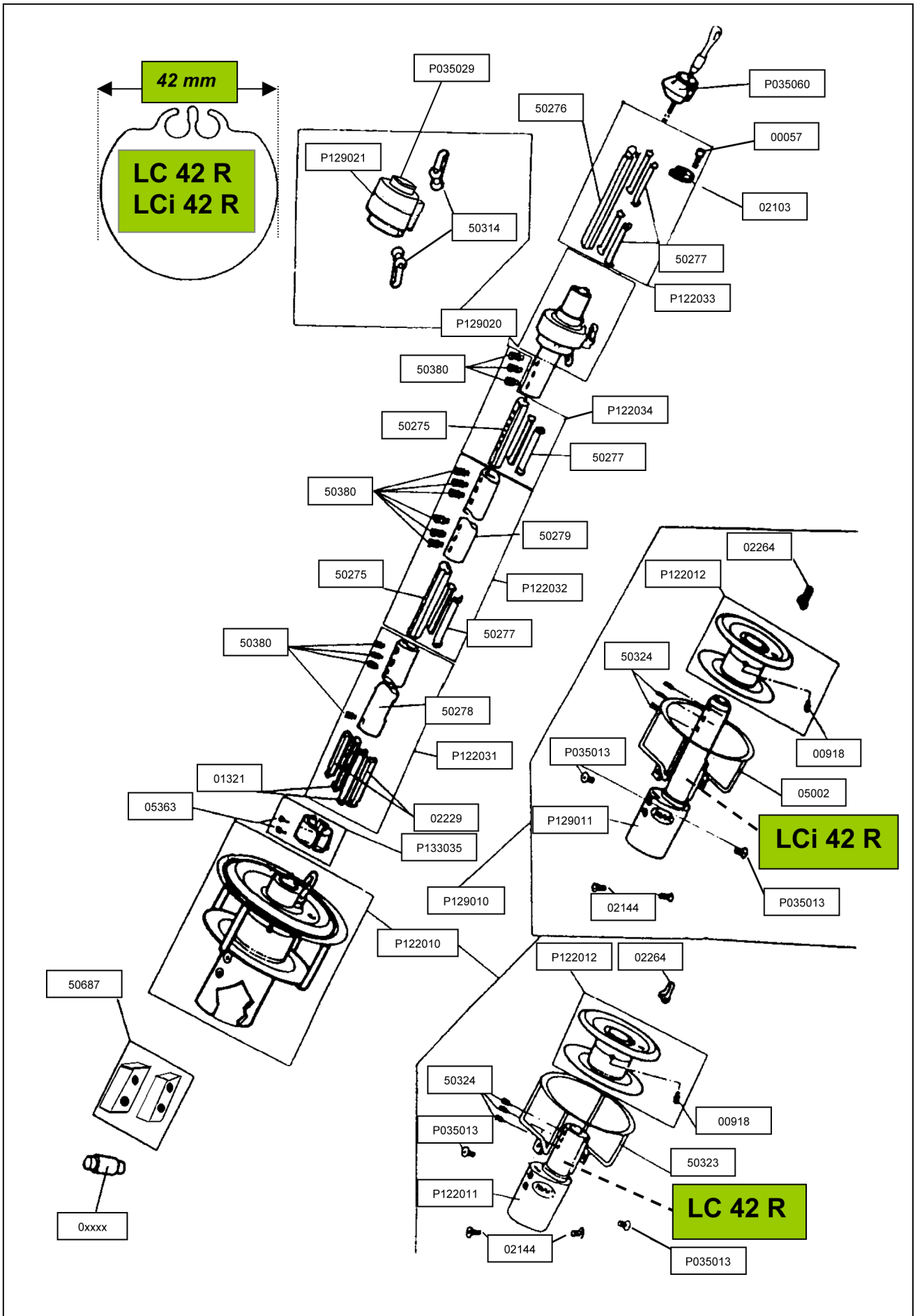



## Bome MK2

Part #	MK2 Parts name
<b>P 177033</b>	<b>Complete sheave box</b>
P 177036	Sheave box only
P177037	Sheave
P177040	Sheave pin and slit pin
<b>P177112</b>	<b>End bracket</b>
50468	End bracket only
50495	Bushing for connector/articulation
P177038	Slide screw for <b>rectangular</b> track and locknut
P177039	Slide screw for <b>round</b> track and locknut
00018	Locknut M 8
<b>P177032</b>	<b>Complete luff profile</b>
02225	Luff profile only
<b>P177034</b>	<b>Complete connector / articulation</b>
P177042	Connector only
50493	Bushing for connector/articulation
00052	Set screw ST HC M6X6
<b>P177041</b>	<b>Articulation bracket</b>
50466	Articulation bracket only
50677	O-ring $\phi$ 4.9 x 1.9
P177038	Slide screw for <b>rectangular</b> track and locknut
P177039	Slide screw for <b>round</b> track and locknut
<b>P177031</b>	<b>Complete feeder profile</b>
50453	Feeder profile only
<b>P177035</b>	<b>Complete feeder</b>
50451	Feeder housing
50445	Feeder rollers adjustment screw (steel)
50579	Feeder rollers adjustment knob (polymer)
50446	Feeder roller
50504	Pop rivet 4 X 13,5 TR
50942	PE screw M6 x 6
50886	Adjustment feeder tool
<b>P177020</b>	<b>Complete gooseneck</b>
50463	Gooseneck or boomvang attachment sideplates
<b>P177045</b>	<b>Kit sideplates + screw and pop rivets</b>
50456	Gooseneck or boomvang sideplates
50486	Pop rivets 4,8 X 16 TF
50546	Stickers
P177038	Slide screw for <b>rectangular</b> track and locknut
P177039	Slide screw for <b>round</b> track and locknut
00018	Locknut M8
<b>P177021</b>	<b>Complete gooseneck articulation</b>
P177022	Complete lower ending bearing holder
50901	Gooseneck articulation only
50903	Vertical pin
50488	Large PE pin washer
50011	Small PE pin washer
00095	SS washer 12
50940	Low aspect nut H - M12
00094	Locknut H - M12
50489	Locknut cap
<b>P177023</b>	<b>Gooseneck pin with split pin</b>
<b>P181011</b>	<b>Drum boom end fitting with pin</b>
50544	Drum boom end fitting only
50977	Spacer steel
50584	Assembling pin for drum boom end
50680	Pop rivets 4,8 X 20 TR
50698	Pop rivets 4,8 X 25 TR
<b>P181004</b>	<b>Complete boom profile 4m</b>
P181011	Drum boom end fitting with pin
P177024	Mainsheet bail
P177130	Complete boomvang hound
50620	Boom profile 4 m (13' 1 1/2")
50483	Mandrel for 4 m (13' 1 1/2") boom
02346	Set screw STHc M8 x 8
50830	Tube 1/2" for rainwater catching
<b>P177012</b>	<b>Drum only</b>
50678	Nylon cheek
02540	Screw TFHc M5 x 12

<b>P181005</b>	<b>Complete boom profile 5m</b>
P181011	Drum boom end fitting with pin
P177024	Mainsheet bail
P177130	Complete boomvang hound
50621	Boom profile 5 m (16' 4 3/4")
50540	Mandrel for 5 m (16' 4 3/4") boom
02346	Set screw STHc M8 x 8
50830	Tube 1/2" for rainwater catching
<b>P177012</b>	<b>Drum only</b>
50678	Nylon cheek
02540	Screw TFHc M5 x 12
<b>P177014</b>	<b>Drum bushing and washer</b>
50460	Drum bushing
50462	Washer LN 16
02346	Set screw STHc M8 x 8
<b>P181018</b>	<b>Rear boom end fitting with pin and pop rivets</b>
50603	Pop rivets 4,8 X 14 TR
<b>P177015</b>	<b>Rear bushing kit</b>
50461	Bearing holder
50455	Rear bushing
50462	Washer LN 16
<b>P177016</b>	<b>Tack slide</b>
<b>P177017</b>	<b>Clew slide</b>
<b>P181019</b>	<b>Clew pin</b>
<b>P177024</b>	<b>Mainsheet bail</b>
02346	Set screw STHc M8 x 8
01659	Mainsheet bail only
50360	Ball bearing block
50344	8 mm ((5/16") furling line
50713	Recommended operating procedure
P51235	(13' 1 1/2") boom brake" 203 C model "
P51236	(16' 4 3/4") boom brake"403 H model "

### BOOMVANG AND ACCESSORY

<b>P181100</b>	<b>Comple boomvang</b>
P177043	Boommvang attachment pin
<b>P177130</b>	<b>Complete boomvang hound</b>
50444	Boommvang hound
50657	SS washer 08
00018	Locknut H - M8

### BOOMVANG ATTACHEMENT

P181210	Boomvang attachment
P177038	Slide screw for <b>rectangular</b> track and locknut
P177039	Slide screw for <b>round</b> track and locknut
00018	Locknut M8
50453	Boomvang attachment only or gooseneck
50456	Boomvang or gooseneck attachment sideplates
50486	Pop rivet 4,8X16 TF
50546	Stickers
<b>P181211</b>	<b>Complete articulation</b>
50803	Articulation eye
50488	Large PE pin washer
50011	Small PE pin washer
00095	SS washer 12
50940	Low aspect nut H - M12
00094	Locknut H - M12
50489	Locknut cap





## MK3

Part #	MK3 Parts name
<b>P180033</b>	<b>Complete sheave box</b>
P180036	Sheave box only
P180037	Sheave
P180040	Sheave pin and slit pin
<b>P180112</b>	<b>End bracket</b>
50557	End bracket only
50622	Bushing for connector/articulation
P177038	Slide screw for <b>rectangular</b> track
P177039	Slide screw for <b>round</b> track and locknut
<b>P180032</b>	<b>Complete luff profile</b>
02237	Luff profile only
<b>P180034</b>	<b>Complete connector / articulation</b>
<b>P180042</b>	<b>Connector only</b>
50622	Bushing for connector/articulation
00052	Set screw STHc M6X6
<b>P180041</b>	<b>Articulation bracket</b>
50556	Articulation bracket only
50668	O-ring $\phi$ 8 x 2,4
P177038	Slide screw for <b>rectangular</b> track
P177039	Slide screw for <b>round</b> track and locknut
<b>P180031</b>	<b>Complete feeder profile</b>
50633	Feeder profile only
<b>P180035</b>	<b>Complete feeder</b>
50573	Feeder housing
50445	Feeder rollers adjustment screw
50579	Feeder rollers adjustment knob
50446	Feeder roller
50603	Pop rivet 4,8 X 14 TR
50942	PE screw M6 x 6
50886	Adjustment feeder tool
<b>P180020</b>	<b>Complete gooseneck</b>
50553	Gooseneck or boomvang attachment
<b>P180045</b>	<b>Kit sideplates + screw and pop rivets</b>
50595	Gooseneck or boomvang sideplate
	Set screw FHc M8 x 25 for gooseneck
50699	Gooseneck or boomvang sideplate
50667	Pop rivets 4,8 X 20 TF
50658	Stickers
P177038	Slide screw for <b>rectangular</b> track
P177039	Slide screw for <b>round</b> track and locknut
00018	Locknut H - M8
<b>P180021</b>	<b>Complete gooseneck articulation</b>
P180022	Complete lower ending bearing
50825	Gooseneck articulation only
50836	Vertical pin
50608	Large PE pin washer
50012	Small PE pin washer
51142	SS washer 14
50941	Low aspect nut H - M14
02258	Locknut H - M14
50659	Locknut cap
<b>P180023</b>	<b>Gooseneck pin with split pin</b>
<b>P180011</b>	<b>Drum boom end fitting with pin</b>
50517	Drum boom end fitting only
50978	Spacer steel
50695	Assembling pin for drum boom end fitting
50603	Rivets pop 4,8 X 14 TP
50698	Rivets pop 4,8 X 25 TR
<b>P180005</b>	<b>Complete boom profile 5m</b>
P180011	Drum boom end fitting with pin
P177024	Mainsheet bail
P180025	Reinforced mainsheet bail
P180130	Complete boomvang hound
50626	Boom profile 5 m (16' 4 3/4")
50616	Mandrel for 5 m (16' 4 3/4") boom
50625	Screw STHc M8 x 8
50830	Tube 1/2" for rainwater catching
<b>P180012</b>	<b>Drum only</b>
<b>Part #</b>	<b>MK3 Parts name</b>
50360	Ball bearing block
50271	10 mm (3/8") furling line
P51236	5m (16' 4 3/4") boom brake " 403 H model "
P51240	6m (19' 8 1/4") boom brake " hyper model "
<b>BOOMVANG AND ACCESSORY</b>	
<b>Part #</b>	<b>MK3 Parts name</b>
<b>P180100</b>	<b>Complete boomvang</b>
P180043	Boomvang attachment pin
<b>P180130</b>	<b>Complete boomvang hound</b>
50693	Boomvang hound
50657	SS washer 08
00018	Locknut H - M8
<b>BOOMVANG ATTACHEMENT</b>	
<b>Part #</b>	<b>MK3 Parts name</b>
<b>P180210</b>	<b>Boomvang attachment</b>
P177038	Slide screw for <b>rectangular</b> track and locknut
P177039	Slide screw for <b>round</b> track and locknut
50553	Boomvang attachment only or gooseneck
50595	Boomvang or gooseneck attachment sideplates
50699	Set screw FHc M8 x 25 for boomvang sideplates
50667	Pop rivets 4,8 X 20 TF
50658	Stickers
<b>P180211</b>	<b>Complete boomvang articulation</b>
50801	Articulation eye
50608	Large PE pin washer
50012	Small PE pin washer
51142	SS washer 14
50941	Low aspect nut H - M14
02258	Locknut H - M14
50659	Locknut cap
51347	Bolt-rope deflector
<b>P180006</b>	<b>Complete boom profile 6m</b>
P180011	Drum boom end fitting with pin
P177024	Mainsheet bail
P180025	Reinforced mainsheet bail
P180130	Complete boomvang hound
50627	Boom profile 6 m (19' 8 1/4")
50618	Mandrel for 4 m (19' 8 1/4") boom
50625	Screw STHc M8 x 8
50830	Tube 1/2" for rainwater catching
<b>P180012</b>	<b>Drum only</b>
51347	Bolt-rope deflector
<b>P180014</b>	<b>Drum bushing and washer</b>
50586	Drum bushing
50655	SS washer 20
50625	Set screw STHc M10 x 10
<b>P180018</b>	<b>Rear boom end fitting with pin and pop rivets</b>
50484	Pop rivets 4,8 X 16 TR
<b>P180015</b>	<b>Rear bushing kit</b>
50612	Bearing holder
50587	Rear bushing
50655	SS washer 20
<b>P180016</b>	<b>Tack slide</b>
<b>P180017</b>	<b>Clew slide</b>
<b>P180019</b>	<b>Clew pin</b>
<b>P177024</b>	<b>Mainsheet bail</b>
02346	Screw STHc M8 x 8
01659	Mainsheet bail only
<b>P180025</b>	<b>Reinforced mainsheet bail</b>
50679	Reinforced mainsheet bail only
50657	SS washer 08
00018	Locknut H - M08
<b>P180012</b>	<b>Drum only</b>





